

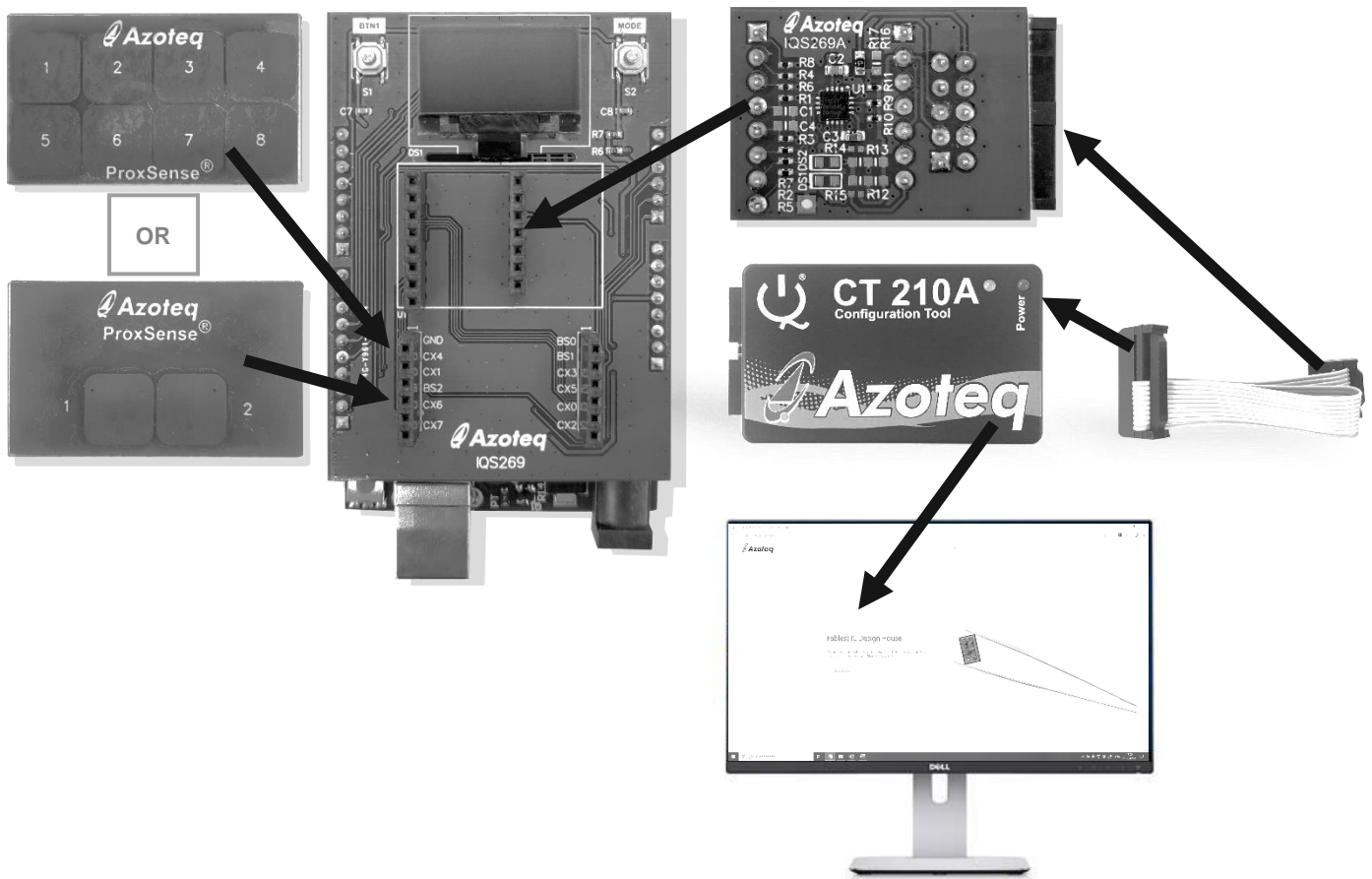

IQS269AEV02 QUICK START GUIDE

Plug either the 2 Button or 8 Button board into the IQS269AEV02 Shield board.
Connect to PC via CT210A¹
Run IQS269A GUI available from Azoteq website.



Select 2 or 8 Button settings in GUI depending on board
Evaluate the module

¹ CT210A Sold separately